

Beer Dispenser

Model No.

DD61-1-HC



DD61-1-HC

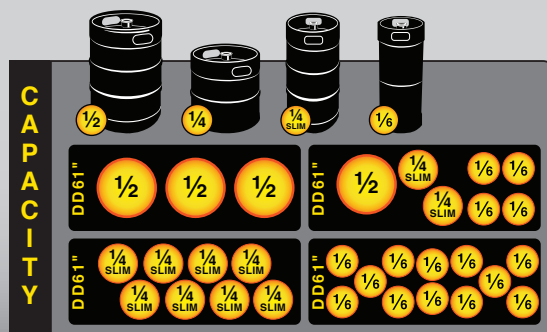

Features:

- R290 HC refrigerant
- CFC free refrigerant and foam
- Electronic thermostat & digital LED temperature display for accurate control & easy reading
- Self-closing door with locks
- Adjustable heavy duty PVC coated shelves
- Magnetic gasket can be replaced without any tools
- Stainless steel top
- Interior: Stainless steel walls and ceiling, 430 stainless steel bottom
- Exterior: Corrosion resistant vinyl on steel in black
- Internal design accommodates a variety of beer kegs
- Installation board is removable for easy access to condenser coil
- 3" Diameter stainless steel insulated beer column. Designed to channel cold air directly into insulated beer column, thus maximizing your draft beer profits by reduced foaming.
- Ships with casters

Warranty Info:

Two Year

- Parts & Labor on entire unit.
- Valid in United States.
- Valid for commercial use only.

Three Year

- Additional Compressor, Part Only.

* See last page for more information.

Revised 02/05/2021

DD61-1-HC



SERV-WARE™

www.servware.com

Phone:(800).768.5953

Fax:(800).976.1299

DD61-1-HC Beer Dispenser



Item # _____
Project : _____
Qty : _____

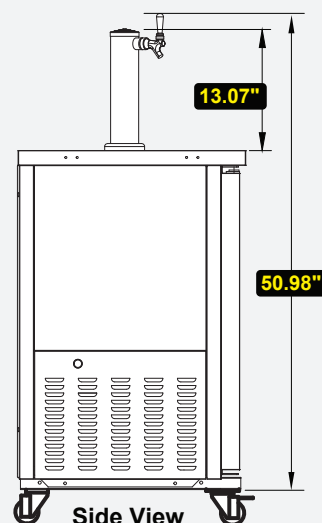
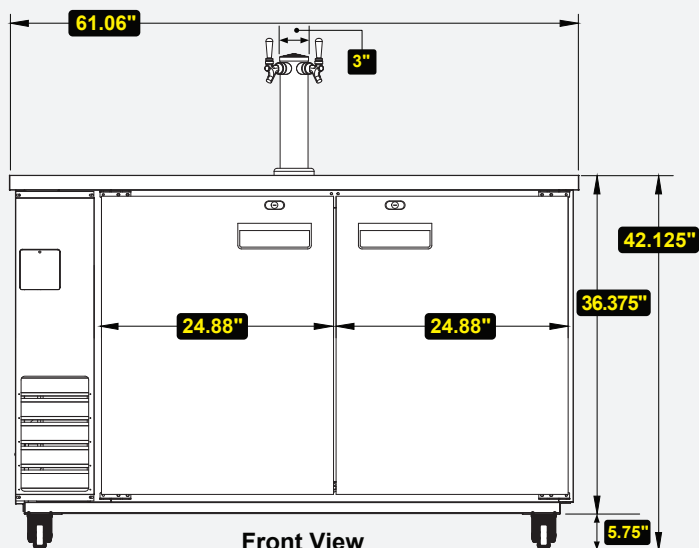

NEMA 5-15P

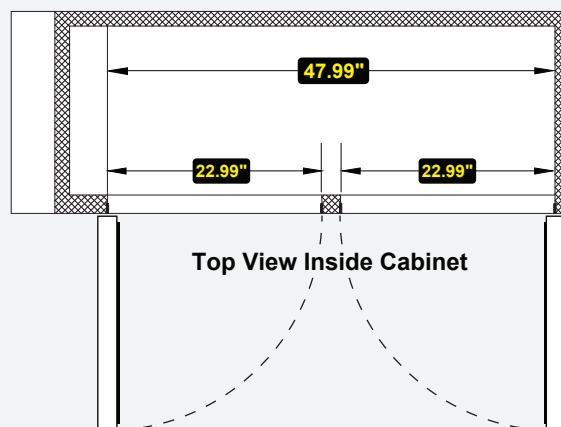
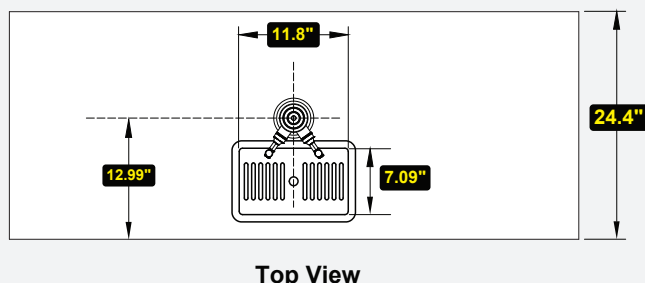

Technical Information:

MODEL #	DESCRIPTION	DIMENSIONS (W x D x H)	WEIGHT/LBS. (Shipping)
DD61-1-HC	1 Tower, 1 Tap	61.06" W x 24.4" D x 42.125" H	315 lbs.

CONSTRUCTION	
Exterior Material	Vinyl on Steel in Black
Interior Material	430 Stainless Steel
Insulation Material	CFC Free Foam
Shelf Material	PVC Coated Wire

COOLING	
Temperature Range	33°F – 41°F
Refrigerant + Charge oz.	R290 / 3.88 oz.
BTU/H	1155
Defrosting	Every 6 Hours
Horse Power	2/5
Storage Capacity	14.16 cubic feet

ELECTRICAL	
Voltage	115
Amps	3
Hz	60
Phase	1

ADDITIONAL INFORMATION	
<i>Installation by certified commercial restaurant equipment installer recommended. Inspection before and after installation by licensed electrician for safe operation. Product designed for <u>commercial interior</u> usage in a climate controlled location with adequate air circulation and not adjacent to a high temperature source.</i>	

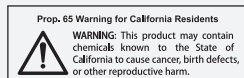

Phone:(800).768.5953
Fax:(800).976.1299

Copyright © 2021 Serv-Ware Products LLC.

www.servware.com